

Alaska Supervoyage

The Ultimate Alaska Itinerary

on MV Swell

A Frommer's "Trip of a Lifetime"



Southeast Alaska breathes majesty: fjords, islands, rivers and tidewater glaciers. Its rich, cold waters support abundant wildlife, from groups of humpback whales, to sea otters, sea lions, porpoises, and millions of seabirds. The land supports even more life, from towering rainforests to lush river estuaries where brown bears, black bears and bald eagles feed. The towns evoke Alaska's history – from Tlingit and Haida to American.

Touch, Taste and Feel Alaska

On board a Maple Leaf boutique expedition cruise, your exploration of this overpowering wilderness differs significantly from the typical cruise ship experience.

You will be part of a small group of only ten guests who wish to experience the grandeur of Alaska by becoming a part of it, not by steaming past it at twenty knots. You'll go ashore on remote islands and experience the silence of the grand Alaskan rain forests. You will see, hear, smell and feel the true wilderness, and learn about it from our experienced naturalist and crew.

Glaciers, Icebergs, Fjords

Traveling through sheer-sided glacial fjords, you will see the powerful forces of nature at work as we experience intimately the tidewater glaciers of Alaska. Picking our way past icebergs in unimaginable shades of blue and through floating pack ice, we will make our way to the face of the glacier itself.

From zodiacs or kayaks we will hear the great thunderous cracking as building-sized chunks of ice calve into the water. We'll likely see seals and their newborn pups snoozing on the icebergs around us.

Islands and Seas with Whales, Seabirds and Other Wildlife

As you cruise on your classic tug, humpback whales the size of school buses rise from the ocean beside

you. You'll be close enough to hear each breath, to feel the spray as it drifts across the deck. With our naturalist at hand, you'll learn about these gentle giants as they feed and dive just feet away.

Our crew knows the best places to find wildlife.

Curious groups of sea lions will seem to enjoy your visit to their colony. We often see rafts of sea otters. Mothers preen the coats of their pups, carrying them on their chests. Seabirds accompany us wherever we are, including many species of alcid, cormorants, loons and ducks.

Bears: Special Access

In quiet anchorages, you'll explore the rich estuaries where land meets sea, the domain of brown and black bears. With Maple Leaf Adventures you will have very special access to the brown bears of Pack Creek on Admiralty Island, one of the densest populations of brown bears anywhere. Access is highly restricted and Maple Leaf is one of very few special permit holders.

Walk the ancient forests that border them and learn from our naturalist of the intricate relationship between forest and sea. Walk sandy beaches to experience Alaska's wilderness from ground-level. Take a morning kayak in a quiet bay.

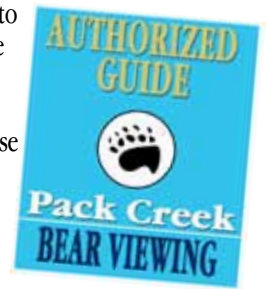



Alaska Supervoyage

"What extraordinary feasts for the body and soul."

- Torie Osborn,

Los Angeles, California

Dates & Prices

2016 - Aboard MV Swell

July 19-27 8 nights, 9 days

Price: Cdn \$7103 (category 1), \$7758

(category 2), \$8216 (category 3)

Depart: Petersburg, AK

Return: Sitka, AK

July 28-August 5 8 nights, 9 days

Price: Cdn \$7103 (category 1), \$7758

(category 2), \$8216 (category 3)

Depart: Sitka, AK

Return: Petersburg, AK

August 6-14 8 nights, 9 days

Price: Cdn \$7103 (category 1), \$7758

(category 2), \$8216 (category 3)

Depart: Petersburg, AK

Return: Prince Rupert, BC

August 15-25 Alaska Supervoyage

10 nights, 11 days

Price: Cdn \$8895 (category 1), \$9730

(category 2), \$10,295 (category 3)

Depart: Prince Rupert, BC

Return: Sitka, AK

August 26-Sep 4 Alaska Supervoyage

9 nights, 10 days

Price: Cdn \$8004 (category 1), \$8741

(category 2), \$9256 (category 3)

Depart: Sitka, AK

Return: Ketchikan, BC

for cabin category descriptions please refer to the Swell ship page enclosed

Maple Leaf Adventures

PO Box 8845, Stn. Central,
Victoria, B.C., V8W 3Z1 Canada

toll free 1-888-599-5323

local 1-250-386-7245



Photo credits: Kevin Smith, Greg Sher (forest)

Frontier Towns and Human History

Alaska's towns and villages are populated by individuals who live in determined isolation, their spirit a legacy of the pioneers in this last frontier.

Islands with names like Baronof, Kruzof, and Kupreanof echo the Russian period of Alaska's history.

You'll explore historic Sitka (layered with Tlingit, Russian and American history), Petersburg (an authentic Alaskan fishing town with a Scandinavian heritage...and ties to our nautical heritage), Ketchikan (steeped in the history of Alaska's gold rush) and the frontier Canadian town of Prince Rupert. You'll also learn about the Tlingit and Haida First Nations (Native American) cultures.



Alaska Adventure - Sample Itinerary (Petersburg-Sitka itinerary)

As with all expedition cruises, itineraries vary depending on guest interest, weather, and wildlife.

- Day 1 Board at Petersburg, cruising Frederick Sound, introduction to Alaskan life, introduction to coastal rainforest on walk. Wilderness anchorage at entrance to fjord.
- Day 2 Cruising spectacular fjord to tidewater glacier, ice bergs, wildlife viewing. Option to zodiac, kayak and/or walk, exploring glacier, ice bergs in this awesome ice world.
- Day 3 Humpback whales of Frederick Sound, Five Fingers Lighthouse, Windfall harbour. Explore estuary and look for brown bears.
- Day 4 Guided brown bear viewing and rainforest walk up salmon creek at Pack Creek on Admiralty Island, with special access for Swell guests.
- Day 5 Frederick Sound marine mammals and islands. Spectacular Baranof inlet and meadow favoured by brown bears.
- Day 6 Cruising to Warm Springs Bay. Rainforest / bog walk and natural hot springs. Cruising the waterfall coast of Baranof Island. Peril Strait to Kruzof Island.
- Day 7 Hike on Kruzof Island through many ecotypes to spectacular west coast beach. Cruising the west coast, sea otters, seabirds.
- Day 8 Weather permitting, exploring by zodiac at St. Lazaria, a spectacular island with thousands of nesting seabirds and rich intertidal life. Vistas of volcanic Mt. Edgecumbe as it sweeps down toward the sea. Hot springs.
- Day 9 Cruise to Sitka for disembarkation.

For Sitka to Petersburg itinerary, reverse the order of the days.

* Permits - Our operations on National Forest Service lands are conducted under a Special Use permit issued by the United States Forest Service. Maple Leaf is an equal opportunity provider.



Photo credits: Greg Siler

Alaska Adventure - Sample Itinerary *(Petersburg to Prince Rupert)*

- Day 1 Board at Petersburg, cruising, introduction to Alaskan life, introduction to coastal ecosystems on walk. Wilderness anchorage.
- Day 2 Rainforest and waterfall walk. Cruising Frederick Sound watching for whales. Visit sea lion haul out; small island anchorage beach walk. Anchor at entrance to fjord.
- Day 3 Cruising spectacular fjord to tidewater glacier, ice bergs, wildlife viewing. Option to zodiac, kayak and/or walk, exploring glacier, ice bergs in this awesome ice world. Evening wildflower meadow walk.
- Day 3 Humpback whales of Stephens Pass. Windfall harbour. Explore estuary and look for brown bears.
- Day 4 Brown bear viewing all day at two sites at Pack Creek on Admiralty Island, with special access for *Swell* guests.
- Day 5 Five Fingers Lighthouse, Frederick Sound, Wrangell Narrows, evening beach exploration and optional kayaking.
- Day 6 South Etolin wilderness exploration - intertidal life, protected islets, black bears. Visit remote, off-the-grid community of Meyer's Chuck with walk ashore.
- Day 7 Ketchikan visit, cruising south through Tongass Narrows to island anchorage. Zodiac tour.
- Day 8 Crossing Dixon entrance watching for group bubblenet feeding whales, orcas, porpoises and seabirds. Island anchorage and exploring chain of islands with shell midden beaches - archaeological sites.
- Day 9 Cruise to Prince Rupert, BC to disembark.

Alaska Adventure - Sample Itinerary *(Supervoyage)*

- Day 1 Board at historic Cow Bay district of Prince Rupert. Cruising and watching for whales. Island anchorage and zodiac explore.
- Day 2 Crossing Dixon Entrance watching for whales, porpoises and seabirds. Tongass Narrows and Ketchikan visit. Cruising to island anchorage. Optional evening kayak.
- Day 3 Visit remote, off-the-grid community of Meyer's Chuck and rainforest walk ashore. South Etolin wilderness exploration by boat and ashore. Exploring intertidal life, islets, black bears.
- Day 4 Scenic Wrangell Narrows cruise, with a view of Alaskan water-based lifestyle. Frederick Sound to Cascade Creek. Rainforest and waterfall hike.
- Day 5 Cruising Frederick Sound, watching for whales. Visit sea lion haul out, small island anchorage beach walk. Visit Five Fingers Lighthouse. Anchor at entrance to fjord.
- Day 6 Cruising spectacular fjord to tidewater glacier, ice bergs, wildlife viewing. Option to zodiac, kayak and/or walk, exploring glacier, ice bergs in this awesome ice world. Admiralty Island Anchorage.
- Day 7 Guided brown bear viewing and rainforest walk up salmon creek at Pack Creek on Admiralty Island, with special access for *Swell* guests.
- Day 8 Frederick Sound marine mammals and islands. Cruising to Warm Springs Bay. Rainforest / bog walk and natural hot springs.
- Day 9 Cruising the waterfall coast of Baranof Island. Peril Strait to Kruzof Island. Wildlife viewing (marine mammals) and shore explorations.
- Day 10 Hike on Kruzof Island through many ecotypes to spectacular west coast beach. Cruising the west coast, sea otters, seabirds.
- Day 11 Weather permitting, explore by zodiac at St. Lázaria, an offshore island with thousands of seabirds and intertidal life. Cruising to Sitka.

For Supervoyage from Sitka to Ketchikan, use this in reverse, and remove first day to Ketchikan.

As with all expedition cruises, itineraries vary depending on guest interest, weather, and wildlife.

Maple Leaf Adventures

PO Box 8845, Stn. Central,
Victoria, B.C., V8W 3Z1 Canada

toll free 1-888-599-5323

local 1-250-386-7245



MV Swell

A classic tug refit into an expedition yacht

The Swell is an authentic, coastal tugboat. Her small size and ruggedness, combined with our special access permits and knowledgeable and well-connected crew, give you an unparalleled experience.

You have access to sites, phenomena and people you cannot get on larger ships, which are often banned from the special areas we take you. What's more, you have a full ship for just you and a few other guests. The cabins are beautifully and lovingly decorated, but they are not hotel rooms. They are authentic, small boat cabins. This means the beds are non-standard sizes but are comfortable. There are door sills to step over to enter each cabin. This does mean that you need to step aboard without thinking of cabins as hotel rooms, but rather as cozy cabins on a real heritage ship.





MV Swell

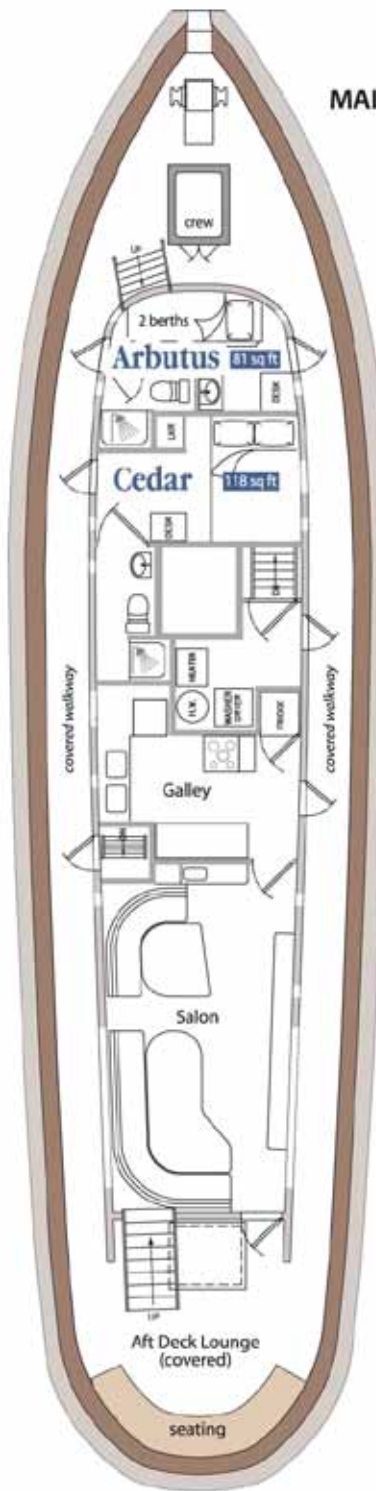

Private Staterooms: 6
 Private Ensuities: All staterooms
 Max Guests: 10 or 12
 Salon / Lounge Areas: 4
 Shore Boats: 2 Kayaks: 2

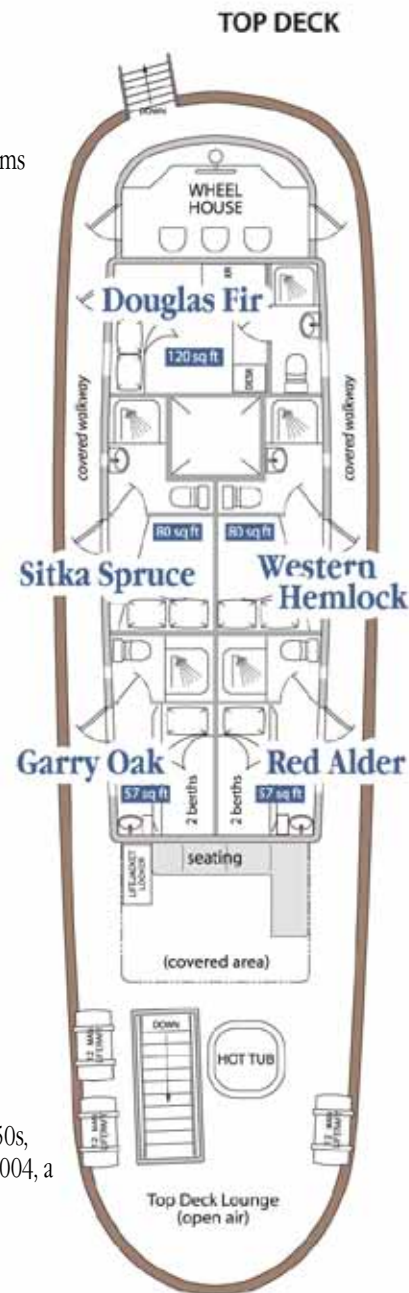

Length: 80 feet
 Beam (Width): 22 feet
 Propulsion: Diesel engine
 Registration: Canada

Year Built: 1912 (rebuilt: 1950s, 1980s, a \$3.5 million refit in 2004, a green refit in 2015)
 Where Built: Vancouver, BC
 Style of Ship: Tug

Cabin Descriptions



Category 1



Outside door, opening portholes, private ensuite head, storage, natural light. Two up and down small, extra-long single beds (79.5" x 30"). Sink in main area, toilet and shower in head. Storage in tall cupboard with shelves, small under-sink cupboard, under bed. 57 ft²
Garry Oak, Red Alder

*Images are representative of cabin categories.
Some aspects of individual cabins may vary.*

Category 2

a) Angled Boat Double



Mid-size cabin, outside door, opening portholes, larger private ensuite head, storage, natural light. Angled boat double beds (approx 79" x 52", narrower at feet). These are comfortable beds for two people used to sleeping together and don't mind their feet near each other. Not for people who wish to sleep well separated from their partner. Luxurious for a single paying a single supplement. 3-piece bathroom. Storage in three small drawers, two cubbyholes under bed, and three shelves, plus cupboard in head. 80 ft²
Western Hemlock, Sitka Spruce

b) Two Singles



Mid-size cabins, outside door, opening portholes, larger private ensuite head, storage, natural light. Two up and down singles (approx 78" x 35"), plus desk and two small cupboards. Sink in main area, toilet and shower in head. Storage in two small wardrobes, shelf on top of wardrobes, cupboard under sink and inside small desk. 81 ft²
Arbutus

Category 3



Largest cabins, outside door, opening portholes, large private ensuite head, storage, natural light. Small boat queen sized bed, which is half-way between a double and a queen (75.5" x 57"). One side of bed is against the wall. 3-piece bathroom. Storage in tall, slim cupboard, various drawers, one shelf and small entry shelf. 119ft²
Cedar, Douglas Fir

Prices are per person. Single supplement for Category 1 and 2 cabins, when available: 50%



BOUTIQUE EXPEDITIONS BY CLASSIC SHIP

ALASKA | GREAT BEAR RAINFOREST | GULF ISLANDS | HAIDA GWAI | VANCOUVER ISLAND

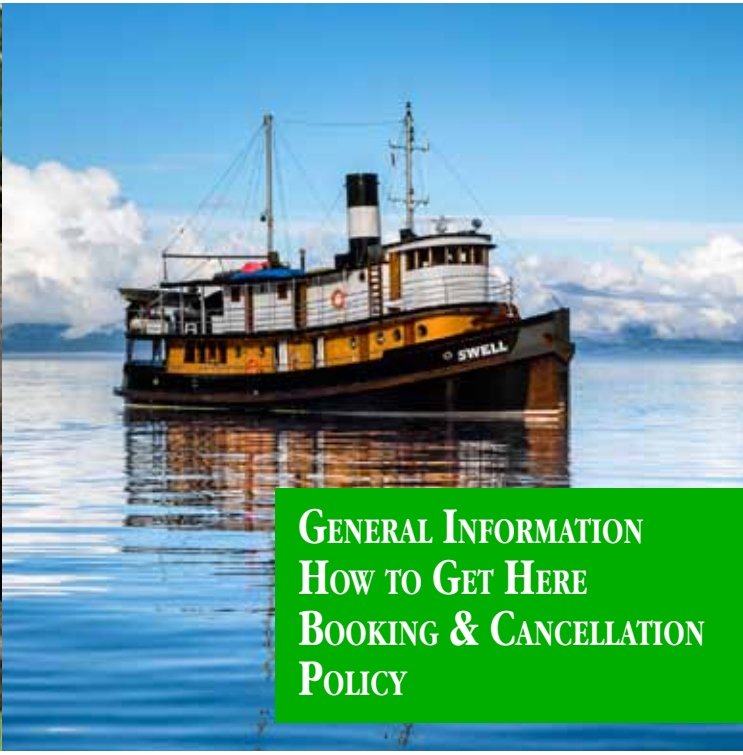

GENERAL INFORMATION
HOW TO GET HERE
BOOKING & CANCELLATION
POLICY



The Trips

Since 1986, trips with Maple Leaf Adventures have been described by guests and international media as the “Trip of a Lifetime”.

Join us and discover the amazing natural wonders of the British Columbia and southeast Alaska coast. Your 5-day to 11-day tour explores this vast paradise of 50,000 islands and 40,000 km of shoreline.

You will travel in the spirit of adventure, aboard authentic, classic coastal ships. Unlike big or pocket cruise ships, these nimble, 8 or 12-passenger boats are a historic part of this coast. They give you the most exclusive access to remote areas and wildlife, while also providing an all-coastal, expert crew, and the luxuries of the good things in life, such as meals prepared by a chef, beautiful surroundings, great companions, and warm comfort.

• Alaska Adventure
The best of Alaska’s inside passage and west coast: glaciers, rainforest, bears, whales, wilderness, towns, culture. Usually 9 days

• Haida Gwaii (Queen Charlotte Islands)
Explore the 150+ islands of “Canada’s Galapagos”, including Gwaii Haanas. Highlights include Haida monumental villages, spectacular whales, ancient rainforest and marine life. Usually 9 days

• Great Bear Rainforest
Cruise the fjords of one of Earth’s largest great wild rainforests, home to grizzly, black and spirit bears, whales and spectacular scenery. Usually 7-9 days

• Whales & Totems of the Rainforest (Broughton Archipelago)
Explore the world of the killer whale, humpback whale and other marine mammals, in the 200+ islands of the Broughton Archipelago. Wildlife viewing, lots of shore trips, cultural sites included. Usually 6 days

• Vancouver Island & Desolation Sound
Explore the diverse inside passage of Vancouver Island and the spectacle of Desolation Sound. From the warm Gulf Islands to steep rainforest in the north. Usually 5-8 days

• Gulf Islands National Park / Salish Sea
Island hop in the new National Park Reserve, visit wildlife colonies, walk the dry rainforest and rocky bluffs, explore remote beaches and tiny islands not visited by ferries. Usually 5-6 days

• Craft Beer, Culinary & Nature in the Gulf Islands
Sample 50 of BC’s top craft beers and learn from an expert brewing historian, while exploring the Gulf Islands and Vancouver Island. Usually 5 days



Photos: Kerin Smith

All-Inclusive Highlights

- All accommodations included in your trip, including comfortable, classic ship-board accommodations with fluffy duvets, and local lodges if your trip includes a lodge stay.
- All shore trips, wildlife viewing, and zodiac excursions guided by our expert, knowledgeable crew/guides. All cultural site visits, and all additional local guides.
- All meals and snacks, prepared freshly for you by our chef. Meals feature great variety, and highlight local, fresh specialties.
- All beverages including coffee, tea, juices and sodas, filtered water, wine and craft beer.
- The services of our naturalist and crew both aboard the ship and ashore. These caring, entertaining and knowledgeable people are your hosts for the trip, always available for questions, teaching, or conversation.
- Open wheelhouse. You are welcome to come into the ship's wheelhouse, from which our crew are navigating the ship. On our sailing ships, you are also welcome to take the helm under our crew's guidance, and help sail the ships, if you like.
- Use of gear on board including kayaks, fishing gear, and rubber boots.

Why travelling by water leads you to the best of the Inside Passage and Haida Gwaii

The coastline of British Columbia and Alaska undulates into bays, twists into island archipelagos, and stretches far down fjords that slice through mountain ranges. This is wild geography and there are few roads here. As a result, wildlife and nature thrive. The few coastal communities have a deep connection to the ocean. To experience it at all, and to reach the richest areas, you must travel by water, as people have done here for millennia. On our small ships, you'll reach special areas closed to big ships, and head down passages and make landings there that big ship passengers can only dream of.

By Travelling with Maple Leaf, You Support Local, Conservation-Based Enterprises

By travelling with Maple Leaf, you are part of the important, emerging conservation-based economy on the coast. Our careful, thoughtful approach to our trips, to nature, and to all of the people we visit have earned us a reputation as a model for conservation travel. We are a coast-owned and operated business, and 99% of the money from the trips stays within the coastal economy. We dedicate time and resources to conservation of the coast -- our home that we gladly share with you.



How You'll Travel



Access to the Best Places on the Inside Passage & Haida Gwaii

Maple Leaf Adventures has been awarded special access permits to protected areas, allowing you entrée to worlds most people will never see. Our relationships can also give access to special cultural sites, and scientists in the field.

Our Small Scale: Feel the Coast's Hugeness

The proximity you will feel to the coast's mountains, forest and islands is incomparable with any other form of water travel. Sail with an escort of dolphins. Feel the spray from waterfalls beside us. Walk in ancient forests that are cathedrals of green.

Timed for Peak Wildlife Events, with Plenty of Shore Time

Our trips are timed to coincide with great natural events, ensuring sightings of a fantastic variety of wildlife including bears, whales, dolphins and hundreds of species of birds. There is always lots to do and see. Our shore trips include visits to intertidal areas, beaches, river estuaries, rainforests, and villages. One of the crew is an expert naturalist or fascinating specialist to help you understand the areas we visit.

Gorgeous Classic Ships with Comfortable Finishings

Our ships are beautiful wooden ships, built here, with long histories on the coast. So even as you walk the deck or step into the wheelhouse, you are having a truly coastal experience, connected to more than a century of history.

The Excitement of a Real Journey

Travelling with a small group of guests means that your experience, while carefully planned, is also natural and spontaneous. You will not feel like part of a crowd, and your experience is not limited by barriers and procedures used to manage large groups. Every second, you are on a real journey. We treat each guest as an individual. We notice your interests and help you to do everything you came for. Every Maple Leaf crew member is welcoming and generous - with their time, their knowledge, and their thoughtfulness.

Expert, Local Guides, Crew & Company

Your trips are developed and operated by us -- expert mariners, naturalists, guides and managers who have grown up exploring the coast and who want you to experience the best of the best.

Veterans of local field research, our naturalists share their expertise and abundant knowledge from real experience here. Our relationships on the coast give you access to researchers and local residents to further enrich your trip.

Natural History Exploration Tools

The ships have excellent natural/cultural history libraries, hydrophones for listening to whales underwater, DVDs, small aquariums, fishing gear, GoPro cameras, kayaks, and top-quality shore boats with clean and quiet engines.

Cultural History

Coastal First Nations guides we work with and who share their long history and knowledge of the place with us are from the Gitga'at, Haida, Haisla, Heiltsuk, and Kitasoo-Xai'Xais, nations, and Kwakwaka'wakw of northern Vancouver Island, and Coast Salish of the southern Gulf Islands.

Full But Unhurried Days

Our days are full but our pace is unhurried, giving time to linger with whales, sketch in a Haida village, beachcomb, and walk ancient forests. We go ashore often to experience the entire place, not just the view.

Typical Activities

- Rainforest walks
- Beachcombing
- Exploring by small boat
- Wildlife viewing
- Coastal village visits
- Cultural site visits and experiences
- Photography
- Natural history learning, in all environments, with our naturalist
- Sailing (sailing ships only)
- Kayaking (optional)
- Hiking (optional; possibly one good hike on a trip)
- Cruising
- Fishing (with a licence)
- Foraging (sea asparagus, berries, and other items, some trips only)
- Whale identification for research (on trips with whales)
- Beach campfire and star watching

The Benefits and Approach to Adventure Travel

This is a trip with a true sense of adventure. It's important to realize it's for people with adventurous spirits. The coastal ships are beautiful and comfortable but they are not Las Vegas. If you seek cruise ship amenities, including grand, hotel-room style cabins, this trip may not be for you.

But if you seek to explore in an authentic way, with the camaraderie of expert crew and guides, we look forward to welcoming you aboard.

The Story of Our Company and People

Passionate About Sharing Our Home with You

Maple Leaf Adventures and our trips are run by people who grew up on the islands and coast of the inside passage and Haida Gwaii.

Our lives and perspectives have grown from the rainforest, the beach, the curious gaze of harbour seals, and the channels of blue water that are the pathways of the coast. Our professional lives have honed our skills at hospitality, wildlife guiding, storytelling, navigation, operations, and other aspects of running a world-class company.

As we have come together at Maple Leaf Adventures, we have created a different kind of trip for you, where you can truly experience the best of life on

the coast, as a guest of expert locals and naturalists. Enjoy the friendship of great residents, smell the sweet coniferous forest as you step ashore, feel the rhythm of ship and ocean as you steer the Maple Leaf, taste the flavour of huckleberries or freshly caught prawns, and hear a whale's sharp inhalation of breath before it dives.

Our purpose is to give you the best of the coast, while also supporting the conservation of its ecosystems and cultural fabric. Our mission is to show that the best travel delights the mind and senses and can enrich, rather than harm, the places we visit. Care and attention to detail are at the heart of all we do.



Kevin's Story

Kevin Smith, the president of Maple Leaf Adventures, has explored the coast by boat since before he could ride a bike. As a young backcountry and marine park ranger, Kevin witnessed the incredible power and beauty of nature, often alone on his patrol boat. He wanted to share it with others.

Kevin is a geographer by training, and he knows the best experiences are beyond roads' reach. To truly explore the landscapes, wildlife and culture of the coast, you need to go by water. But not in the traditional manner, with thousands of people on a huge cruise ship. He wanted to share the glory of the coast as he had gotten to know it.

He volunteered for five years on the team that

created British Columbia's ground-breaking land use plan, which preserves large tracts of the Great Bear Rainforest. The process pointed out a needed solution in the area: a conservation-based economy. Kevin realized that his vision of sharing the coast's wonders with others would fit. His business acumen, green ethics, expedition knowledge and love of hosting lead him to a new kind of travel: eco-adventure cruising.

Since 2001, Kevin has built Maple Leaf Adventures into an award-winning company. As the leader, he must spend time in the office. But he (as with all Maple Leaf Adventures staff) stays focussed by donning his GoreTex jacket and operating trips each year. It keeps him in touch with the interesting



guests who join us, and the geography, wildlife and people of the coast. After all, that's the dream that brings us - and you - together.



About Our Company

Maple Leaf Adventures has been operating trips focused on the natural history of B.C.'s west coast and Alaska, and the culture of the First Nations peoples of the areas, since 1986. We have a reputation for quality, professionalism and sensitivity to natural and cultural landscapes.

Our institutional clients have included the Royal BC Museum and The Canadian Museum of Civilization. Our company has been recognized by the Canadian government as a leader in eco-tourism and our trips have been featured internationally in such travel guides as *Frommer's* and *National Geographic Traveler* and on the Oprah Winfrey television show.

We dedicate time and resources to coastal conservation, caring for the coast that gives us our livelihood.





Frequently Asked Questions

Q. Is this trip suitable for me?

A. Anyone is eligible so long as they are enthusiastic about participating, amenable to the vagaries of weather, agile enough to clamber in and out of shore vessels in an area where there are no docks, and friendly enough to get along in the relatively close quarters of a yacht. We have had people on board as much as 80 years of age. However, our trips are not suitable for people of failing health or physical disabilities.

Q. What is included in the price?

A. Our price includes all meals, activities and guides throughout your voyage in the region you are visiting. Specifically:

- All meals, snacks and beverages prepared from the freshest ingredients by our superb chef.
- Fine wines featured with the evening meal, and a limited amount of beer included and available throughout the trip. (Liquor is not a large part of our trips, so plan on light consumption).
- Services of our naturalist and professional crew.
- Shore excursions.
- Use of gear on board, including raingear, boots, kayaks and fishing gear (*with fishing licence*).

Not included in our price:

- Transportation to the trip's point of origin.
- Goods and Service Tax (Canadian trips only)
- Crew gratuities
- Sustainability Fee. As a professional ecotourism company, it is at the core of our operating principles to work with local communities, respecting regulations and contributing to local opportunities. Responsible operations cost a little more. We extract from the fare a

percentage of the increased costs that go towards sustainable communities add it to the list price as a 'sustainability fee' of \$100 per trip. Through it we hope our guests share in the pride that a trip with Maple Leaf is a contribution to the sustainability of the whole coast – as well as being a great experience.

Q. Can you accommodate my special diet?

A. Yes. If you advise us in the pre-trip forms we can accommodate most dietary requirements.

Q. Will I be seasick?

A. Sea sickness on our North America trips is rarely a problem as your trip is on a sturdy and sea-kindly ship. We travel short distances in protected waters and go ashore often.

Q. Can I be involved in sailing the ship and performing other duties?

A. In North America, absolutely. We encourage our guests to participate in any aspect of the trip that interests them and to a level they are comfortable with. We are patient instructors (no yelling) and delight in helping people learn. On the other hand, you are not required to sail or perform duties while on your vacation. The choice is yours.

Q. What makes you an eco-tourism company?

- A. • Our trips have low impact (virtually no impact) on the planet and on the places we visit
- We partner with local people. We have protocol agreements either signed or in process with First Nations in territories we visit.
 - Our naturalists – experts in their fields – and other knowledgeable crew members provide a wealth of knowledge on the areas we visit, as do our First Nations guides.

- We work within the regulations of parks and conservation areas, pay the applicable fees and obtain permits for all limited-use areas we visit.
- We dedicate time and resources to preserving the wilderness we travel in.

Q. I've never been on a boat before – is that OK?

A: Yes, absolutely. You will be travelling on a large, strong boat run by an expert crew. You are aboard as our guest and we will look after you very well. You don't have to do anything other than enjoy yourself.

Q. Will I go ashore?

A. Yes – usually a few times a day. Each shore trip is usually between 1 and 3 hours in length.

Q. Do you have kayaks?

A. Yes, and you are welcome to go for paddles in the spectacular bays we anchor in.

Q. How long have you been operating?

A. Since 1986.

Q. How many people are typically on a trip?

A: In North America, max ten guests. We have a crew of 4 or 5 including chef and naturalist.

Q. Is there a single supplement?

A. On the Maple Leaf, there is no single supplement. If the trip fills, you will share with another single person of your own sex. On the Swell there is a 50% single supplement.

Q. What are the other guests like?

A. Our guests are people like you, who are interested in high quality experiences and in learning about the natural world, classic ships or culture. They are thoughtful, fun people and a joy to travel with. A large percentage of them return for additional trips.

How to Get to Your Trip

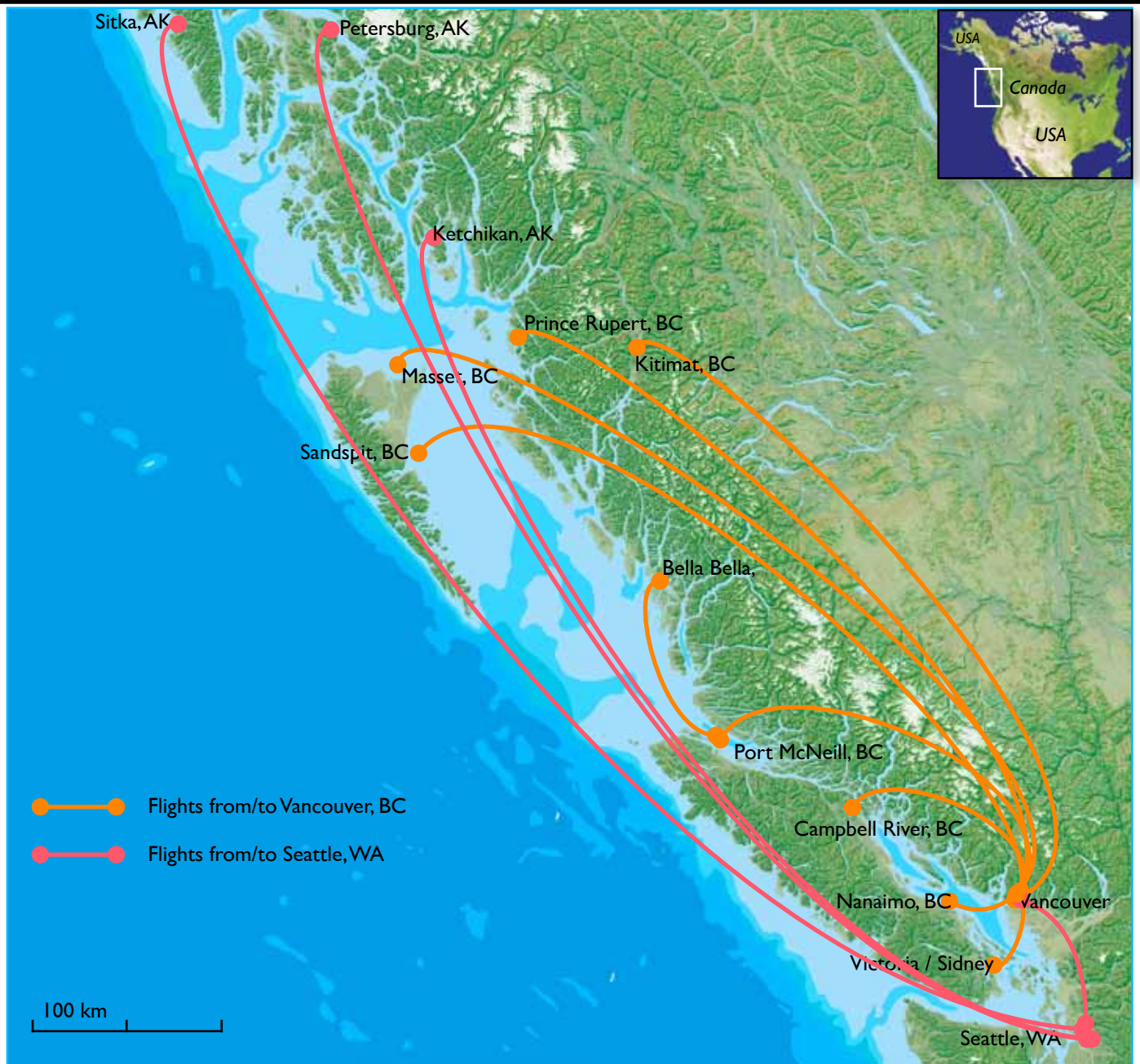

Airport Access

Our BC and Alaska trips originate from ports along the coast that are serviced by regularly scheduled flights. All of these flights except one originate from Vancouver International Airport, in Vancouver, BC. If you are flying from outside the area, and you are wondering where you need to get to in order to connect to your trip, then Vancouver International Airport is the answer.

Note that if your Alaska trip either starts at or ends at a port in Alaska (e.g., Petersburg), then any air travel to or from Alaska goes via Seattle-Tacoma airport, in Washington State, USA. You can connect to Seattle via a short flight to or from Vancouver, BC.

The map above shows the general flight routes.

We provide all of this information plus more detail and guidance in the Welcome Aboard package that you will receive upon booking your place with Maple Leaf. We are also happy to help any time!

Ferries

Ferries transport passengers between Vancouver and Victoria, Vancouver and Nanaimo, Port Hardy and Prince Rupert, Prince Rupert and Haida Gwaii, Seattle and Victoria, and Alaskan ports and Prince Rupert. Travelling by ferry requires careful planning and sometimes a car.

Driving

If you wish to drive to and/or from your trip, you may be able to. It's best to email or phone us or your travel agent for further information.

Staying Beforehand or Afterward

Our Welcome Aboard packages lists some places you may wish to stay at before or after your trip.

Travel Agent

If you would like the assistance of a travel agent, we are happy to provide contact information for one who has worked with our guests.



Wild BC and Alaska - Boutique expedition cruises



Booking and Cancellation Policy

To avoid disappointment, your reservation should be made early. The number of participants in each program is limited, and the demand is high. Our trips sell out early.

Deposit: A deposit of one third of the price of the trip will reserve your space for any trip.

Balance: The balance is due 120 days prior to departure.

Cancellations: If you are unable to participate and cancellation occurs at least 120 days prior to the departure date of your trip, the full amount of your deposit is refundable, minus a \$200 admin fee per person to cover costs we cannot recover. If cancellation occurs less than 120 days prior to the departure date of your trip, we will do our best to try to fill your space on the trip, however no money will be refunded unless all the spaces on your trip are filled.

Group Bookings

For large group bookings, such as a family charter of the entire ship, the booking and cancellation policy may be different - please do contact us for information.

Cancellation Insurance

We highly recommend cancellation insurance, which protects you if you have to make a late cancellation in certain cases (such as a medical emergency). There are

several kinds available for different cancellation reasons. Cancellation and any needed medical insurance can be purchased through a travel agent. This should be done at the time your booking is nonrefundable.

Pre-Trip Information Package

We will send you a comprehensive Welcome Aboard package when you book your place. It includes information on clothing and other items to bring, how to get to your trip, a bit more about travelling in the area, forms to fill out and return to us and a reading list if you like to do pre-trip reading.

Full Ship Charters

Charter an entire trip for your family and friends. Contact us for full ship charter pricing.

Note: Full ship charters require advance planning, as the trips are popular and once a trip has bookings, it can no longer be exclusively yours.

How to Book Your Trip

To book, we welcome your call or email. We complete bookings by telephone.

For deposit payments we accept Visa, Master Card, cheque, money order or bank transfer. For final balance payments we accept cheque, money order or bank transfer.

"Thanks for the best vacation ever."

- Carrie Novick, Oregon.

Contact Us

To book a trip or for help with any questions you may have, we welcome your call or email.

Maple Leaf Adventures

PO Box 8845, Stn. Central,
Victoria, B.C., V8W 3Z1 Canada

info@MapleLeafAdventures.com
toll free 1-888-599-5323
local 1-250-386-7245