

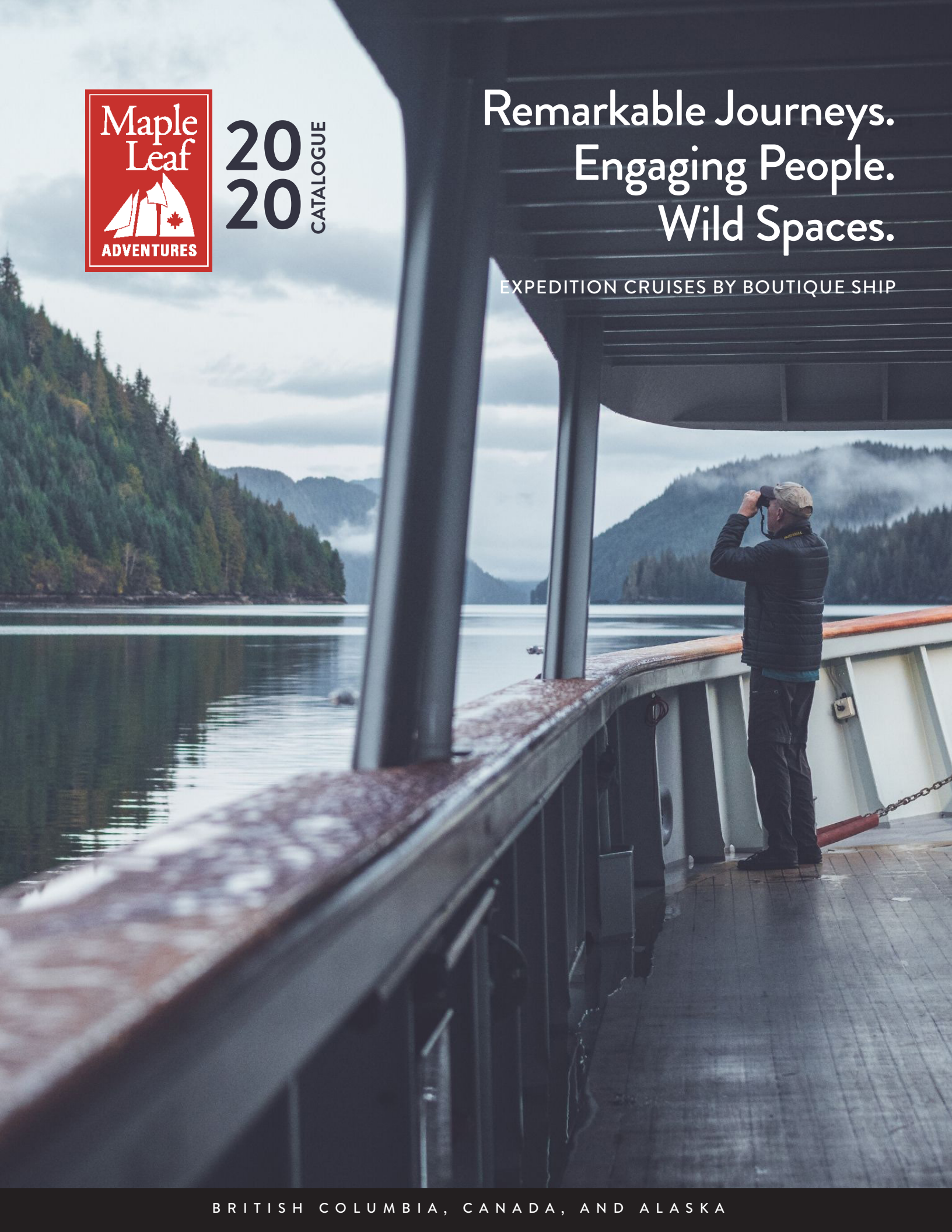

20
20 CATALOGUE

Remarkable Journeys. Engaging People. Wild Spaces.

EXPEDITION CRUISES BY BOUTIQUE SHIP



BRITISH COLUMBIA, CANADA, AND ALASKA

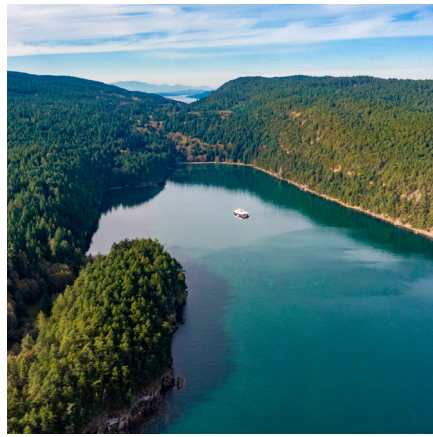

BRITISH COLUMBIA, CANADA

Broughton Archipelago
Desolation Sound
Vancouver Island
Gulf Islands National Park

2 BOUTIQUE SHIPS

MV Swell
MV Cascadia

INTRODUCTION

Why Our Ships Give You the Best of the Inside Passage and Haida Gwaii

The coastline of British Columbia undulates into bays, twists into island archipelagos, and stretches far down fjords that slice through mountain ranges.

This is wild geography. There are few roads. As a result, wildlife and nature thrive. The few coastal communities have a deep connection to the ocean.

To reach the richest areas, you must travel by water, as people have done for millennia.

Our tiny ships access a world closed to bigger ships. Our permits and First Nations protocol agreements, combined with our crew's local knowledge, give you exclusive reach to special areas, wildlife and people.

Personalized and Enriching

With just limited guests per trip, you travel as our welcome guest, not part of a crowd to be managed. The proximity you will feel to the coast's mountains, forests and life is incomparable with any other form of cruising. Every moment is part of a real journey.

Enjoy the friendship of residents. Smell the sweet coniferous forest as you step ashore. Feel the rhythm of ship and ocean as you steer under crew's guidance, taste the flavour of huckleberries or freshly caught prawns, and hear a whale's sharp inhalation of breath before it dives.

Our purpose is to delight and inspire you, while also benefitting our ecosystems and social fabric. Care and attention to detail are at the heart of all we do.

Local Guides

Everyone is a local - from naturalist to chef - with insights to share. Often they are involved in ongoing coastal research, community building, and the care of our unique ships. All are handpicked for their mastery and expertise. They are happy to share their knowledge with you - expert mariners' intimate understanding

of coastal bathymetry and weather; chefs' knowledge of how to make delicacies from nettles; naturalists' understanding of bears' body language; visits with local researchers who understand the latest patterns and behaviors of humpback whales.

Typical Activities

- » Rainforest walks
- » Beachcombing
- » Exploring by small boat
- » Wildlife viewing
- » Natural history interpretation
- » Beach campfire and star watching in dark skies
- » Cultural experiences and site visits
- » Photography
- » Kayaking (optional)
- » Hiking (optional; possibly one good hike on a trip)
- » Fishing (with a licence)
- » Foraging (sea asparagus, berries, etc., some trips only)

Eco-Tourism

Our approach is to enhance, rather than take from, our home, to give you an exceptional experience that also leaves a legacy. Ever since our inception 30 years ago, we have celebrated, partnered with and funded nature conservation and cultural communities, including indigenous communities and guides, where we operate.

Spontaneous Adventures

Our itineraries are flexible to give you the best experience possible; true open itineraries in the spirit of exploration and discovery. If you seek to explore in an authentic way, with the camaraderie of expert crew and guides, we look forward to welcoming you aboard.

Is Adventure Travel for You?

This is a trip for people with adventurous spirits. Our ships are beautiful and comfortable but if you seek urban or cruise ship amenities, including shows, shopping and 24-hour-a-day alcohol, this trip may not be for you.



Kevin and Maureen say farewell to Cascadia before she joins the other ships on her first trip of 2019.

A Letter from Kevin: Our Coastal Community

Dear Friends,

We are pleased to introduce you to the wonder and soul of the spectacular coastline we consider ourselves fortunate to spend our lives on.

We know that your holiday time is precious and we are grateful you have chosen to spend it here.

Although in geological time, Maple Leaf Adventures' 34 years of history is a blip, in our time, it has enabled us to build deep, meaningful connections with places and people all along the coast's stunning breadth.

We sometimes say that the coast is like a small town -- a 1,000 kilometre-long small town. Whether we're in Sitka or Bella Bella or Ganges, we share a marine-based culture. We're connected even when we can't see one another -- by the usual methods, by our travels and visits ashore, and also by the marine radio that's a lifeblood of the coast.

Welcome aboard. Join us to explore the thousands of islands that make up the Inside Passage and Haida Gwaii.

And we're connected by our pride in doing great work to keep our coastal economies alive and healthy.

All of us -- from the local shipyard workers who did amazing things to bring our third ship, Cascadia, to life, from the guides who steer you to that special wildlife spot, to the folks in the office making arrangements -- all of us welcome you to the Maple Leaf Adventures family and, by extension, to our coastal community.

Thank you.

Kevin Smith and Maureen Gordon
Co-Owners



DESTINATIONS



About the Itineraries

In each destination that follows, we list the sample itinerary for each trip. The itineraries show the route and events of a typical trip. Note, that our itineraries are flexible, to accommodate the actions of wildlife, weather and special events we encounter. Our expert crew know how to combine the highlights of each area, and in the right order, to provide the best possible trip each time.

DESTINATION

GULF ISLANDS & SALISH SEA

ITINERARY DETAILS - SAMPLE

Autumn in the Gulf Islands

Swell

Oct 19-23

\$5,125 CAD (cat. 1)

\$5,590 CAD (cat. 2)

\$6,100 CAD (cat. 3)

Oct 24-27

\$3,800 CAD (cat. 1)

\$4,200 CAD (cat. 2)

\$4,550 CAD (cat. 3)

DEPART AND RETURN:

Nanaimo, BC

DAY 1

Orientation, cruising. Seabird island visit, wildlife watching, porpoises. Anchorage Saturna Island.

DAY 2

Morning hike on Saturna Island, forest ecology learning. Cruising, beachcombing a remote island, sea lion and seabird haul out. Wild life viewing through the gulf islands

DAY 3

Cruising in Georgia Strait and one of many channels in the area. Anchorage Prevost Island. Exploring the inter-tidal life at low tide. Hike to view and mariner's light.

DAY 4

Visit the small, inner islands: Wallace Island for an idyllic walk, Penelakut Island with ancient First Nations history. Wildflower meadows or mushrooms and fall foliage highlights (seasonal). Cruising to Russell Island. Optional kayak.

DAY 5

Morning woodland shore walk. Kanaka and Salish history. Cruising to Nanaimo.

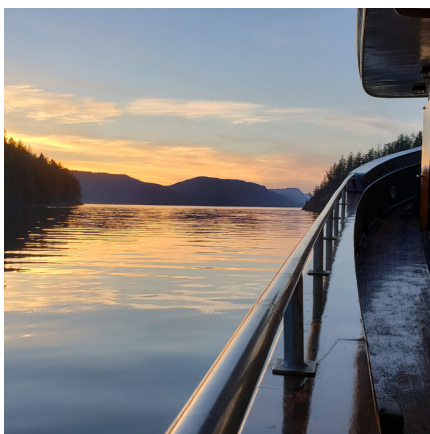

ITINERARY DETAILS - SAMPLE

ITINERARY 3

Craft Beer Culinary Cruise

SHIP:

Swell

Oct 28-Nov 1

\$5,290 CAD (cat. 1)

\$5,750 CAD (cat. 2)

\$6,300 CAD (cat. 3)

DEPART AND RETURN:

**Nanaimo, BC
Sidney, BC**

DAY 1

Welcome aboard. Introduction to world of beers, brewing history and tasting. Seabird colony visit, cruising scenic Samsun Narrows. Tasting dinner aboard with social history of BC beer discussion.

DAY 2-3

Island hopping. Explore Ruxton Island and local legend ashore in the morning. Cruise to Ladysmith and tasting lunch at Crow and Gate pub. Cruise to beautiful Montague Harbour, Galiano Island or Wallace Island for shore walk. Cruising north through the Gulf Islands. Brewery tour and tasting, guided by brewmaster.

DAY 4

Island cruising to outer Gulf Islands. Wildlife viewing at small chain of islands that hosts birds and marine mammals. Beach-combing and historic farmstead exploration at Cabbage and Tumbo Islands at midday. Afternoon walk to spectacular Monarch Head on Saturna Island with view of Canada/USA boundary and surrounding islands.

DAY 5

Cruising and watching for wildlife en route to Sidney.

ITINERARY 4

Wines & Islands

SHIP:

Cascadia

Oct 25-29

\$5,650 CAD (cat. 1)

\$6,550 CAD (cat. 2)

\$7,500 CAD (cat. 3)

DEPART/RETURN:

**Nanaimo, BC
Sidney, BC**

DAY 1

Board at Nanaimo. Welcome aboard toast and tasting. Under way, transiting scenic passageways in northern Gulf Islands. Introduction to BC wines, terroir and history, what makes the region noteworthy. Shore walk in marine park. Tasting dinner that provides an overflight of the wines and what we'll explore in the coming days.

DAY 2-3

Vancouver Island wines feature. Morning shore trip at Penelakut Island. Cruising scenic Samsun Narrows. Visits with the leaders of Cowichan valley winemaking, discussion, tasting meals, vineyard walks. Vancouver Island wine dinner. Anchorage Pender Island. Gulf Island & other regions wines feature. Morning shore walk in Gulf Islands rainforest, and/or kayaking, Pender Island. Sea Star winery visit. Cruising Boundary Pass looking for wildlife. Very scenic walk to spectacular vista for picnic.

DAY 4

Okanagan and Similkameen wines feature. Optional morning kayaking. East Point historical site visit and exploring Boiling Reef, watching for wildlife. Learning and tastings featuring Okanagan and up-and-coming Similkameen region wines, wine history, terroir and culture. Wildlife viewing at Belle Chains and afternoon remote beach and historic homestead exploration at Cabbage and Tumbo Islands. Evening Okanagan and Similkameen tasting dinner.

DAY 5

Morning shore exploration at Russell Island. Wrap up, cruising, looking for wildlife.

OVERVIEW

“An unbelievable experience with the most dedicated and involved crew I’ve ever experienced. Every day was ‘magical’. The bar for my next adventure now is high! A true way to tick off a bucket list item in such a successful way. Thanks so much to all the fabulous crew.”

- Chuck C., 2017

Access a spectacular mountain world through rural island waterways.

Sail beneath glaciated peaks, rainforested hillsides, and expansive waters that turn into secret coves you will explore.

While Desolation Sound is one of the world’s most popular cruising destinations, you will enjoy the area in a unique way: without the bustle of other boaters. By touring Desolation Sound and the Discovery Islands in May, you’ll enjoy the fjords, islands, wildlife, and forest trails in peace – as immortalized in the popular book *The Curve of Time*.

Special Features

- » Beautiful vistas of one of BC’s most breathtaking fjords.
- » Hikes from the beach, along rivers and waterfalls to BC’s warmest lakes.
- » Visit one of BC’s most prolific bird sanctuaries (Mitlenatch Island).
- » Historical stories about early pioneers and homesteaders told around the campfire
- » Natural foods foraging with your own private chef.
- » Other wildlife viewing, including seals, sea lions and possibly a spring bear.

DESTINATION | DESOLATION SOUND



DESTINATION

DESOLATION SOUND

ITINERARY 1

ITINERARY DETAILS - SAMPLE

Desolation Sound and Fjords of B.C

DATES & PRICES & SHIPS:

Cascadia

Oct 10-17

\$9,950 CAD (cat. 1)

\$11,550 CAD (cat. 2)

\$13,200 CAD (cat. 3)

DEPART AND RETURN:

Port McNeill, BC Comox, BC

Swell (one day longer)

Oct 10-18

\$10,300 CAD (Cat 1)

\$11,300 CAD (Cat 2)

\$12,300 CAD (Cat 3)

DEPART AND RETURN:

Port McNeill, BC Nanaimo, BC

ITINERARY 2

Desolation Sound

DATES & PRICES & SHIPS:

Cascadia

Oct 18-22

\$5,650 CAD (cat. 1)

\$6,550 CAD (cat. 2)

\$7,500 CAD (cat. 3)

DEPART AND RETURN:

Comox, BC

DAY 1

Board vessel and cruising to anchorage in the Broughton Archipelago while watching whales. Hike to spectacular view.

DAY 2

Visit Alert Bay and possibly U'mista Cultural Centre with a private guided tour. Evening cruising to island anchorage for alfresco dinner, keeping eyes and ears out for wildlife.

DAY 3-4

Exploring the cascades and waterways of Desolation Sound, with two shore trips to explore the marine park, in Prideaux Haven and

Redonda Island. Aft deck barbecue and bubbly.

DAY 5-6

Visit the isolated Mitlenatch Island. Exploring the island by small boat, watching for nesting seabirds. Cruise to south to Discovery Islands. Possible anchorage at Lasqueiti Island.

DAY 7-8

Explore Discovery Islands and adjacent inlets, watching for marine mammals. Intertidal exploration. Visit with marine mammal researchers. Slowly make our way to Comox.

DAY 1

Welcome aboard and cruise to Cortez Island. Rainforest walk with naturalist. Local community visit. Welcome dinner.

DAY 2

Cruise to spectacular Teakerne Arm, where a waterfall plunges down a steep cut beside the ship. Walk to a lake with a picnic lunch. Cruising the scenic passages. Evening shore trip.

DAY 3-4

Sail or cruise into Toba Inlet. This

spectacular fjord, 35 km long, cuts deep into the coast mountains. As you cruise the snow-capped peaks tower above. Watch for seals and sea lions, seabirds, bear and other animals. Anchorage at Prideaux Haven, at the confluence of Malaspina Inlet and Homfray Channel. Cruise to the Copeland Islands.

DAY 5

Explore bird and sea lion colony Mitlenatch Island by boat. Cruise to Campbell River.

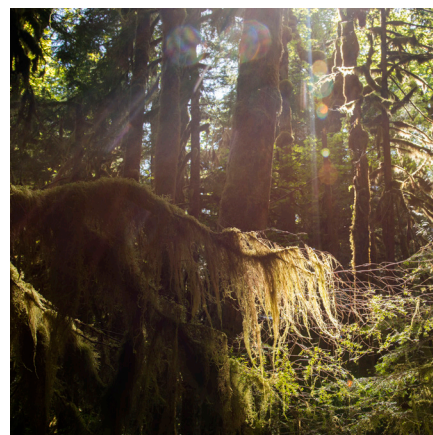



“We saw and experienced so much, the food was incredible, we met and made friends with the other guests. Nothing more to say -- it simply exceeded our expectations on so many levels.”

- Alec W. on TripAdvisor, 2016

“Some nights I hear whales in my dreams. Some nights I wake... and find it hasn't been a dream at all.” – Alexandra Morton

This is the “Serengeti of the sea”: rich in wildlife, home to a complex whale community, addictive cruising and ancient human cultures. It is the best place on earth to see killer whales and humpback whales. It is rich in seabirds, porpoises and other ocean life. On forested islands and on the water, humans have also thrived for millennia and this trip will introduce you to the ancient and modern First Nations culture, and to other inhabitants of floating hamlets.

Special Features

- » Watching and learning about whales and how they live, for hours in comfort, with our flexible itinerary and expert guides.
- » Visits to tiny coastal places such as the boardwalk community of Telegraph Cove, the historic Kwak-waka'wakw site at Village Island, and Alert Bay, a community that is home to the spectacular Kwak-waka'wakw cultural centre, U'mista.
- » Cruising intricate channels and island hopping, viewing seabirds and perhaps even a black bear swimming while under way
- » Rainforest walks and, time permitting, exploring the rich nature of a mainland inlet estuary.



DESTINATION | BROUGHTON ARCHIPELAGO

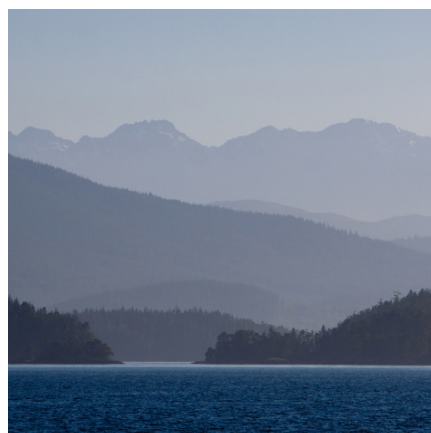

DESTINATION | BROUGHTON ARCHIPELAGO & GREAT BEAR RAINFOREST

ITINERARY DETAILS - SAMPLE

AUTUMN

Experience the area quiet without boat traffic as the yachting season ends and few remain to marvel at the autumn Watch as humpback whales display incredible acts of feeding. Known to be the best time of year to watch these gentle giants. Witness late salmon runs and a multitude of bald eagles. Happen across transient (marine mammal-eating) killer whales, prowling for their next hunt.



ITINERARY 1

Whales & Totems of the Broughton Archipelago

SHIP:

Swell

Sept 30- Oct 4

&

October 5-9

\$5,125 CAD (cat. 1)

\$5,590 CAD (cat. 2)

\$6,100 CAD (cat. 3)

DEPART AND RETURN:

Port McNeill, BC

DAY 1

Board the ship, orientation, sailing.
Humpback whale & porpoise viewing.
Optional evening kayak.

DAY 2

Killer whale watching for hours.
Lunch in the company of whales.
Afternoon forest interpretive walk,
intertidal life exploration.

DAY 3

Village Island ancient Kwakwa-
ka'wakw village site, personal guided
tour at U'mista Cultural Centre,
Alert Bay. Cruising mainland fjord,
river estuary walk, search for bears.
Optional kayak, zodiac ride.

DAY 4

Humpback whale viewing. Shore
walk and intertidal life viewing. Visit
remote Echo Bay float house commu-
nity and Billy Proctor's Museum.

DAY 5

Whale watching or dolphins, cruising
to Port McNeill.



“A true connection with nature
at its purest.”

- N. Tomich, 2016



COVID-19 POLICIES & UPDATES FALL 2020

Our top priority is ensuring the safety and health of the Maple Leaf Adventures guests and crew, as well as respecting the coastal communities we operate in. As a professional ecotourism company that has been operating in our coastal home for over thirty years, we make decisions with long-term thinking. To ensure everyone's safety throughout the trip, we have adjusted our policies. As new information evolves, we will continue to adapt our policies.

Before departure:

- Guests must review and sign the self-assessment information provided. The standard online self-assessment tool for BC is BC Thrive Health. Anyone experiencing symptoms will not be permitted to participate in the trip.
- For Fall 2020, we will only accept guests from specific jurisdictions and/or guests who have been in a 14-day quarantine period in BC. This policy is still being developed, details will be available shortly.
- Crew have been tested and isolated before working on board.

During the Trip:

- Crew and guests will be monitored daily for Covid-19 symptoms. Anyone who experiences an onset of symptoms will be asked to self-isolate within their cabin. Self-isolation should continue for a period determined by the self-assessment tool, as well as following consultation with a medical practitioner. We have the ability for guests to be removed by medivac from the ship and would make appropriate arrangements for that if needed.
- Non-medical face masks will be required for both guests and crew anytime 2 metres of physical distance cannot be maintained. For example, during all trips in the tenders and on board briefings. Crew will be wearing masks during meal service.
- Crew will have access to appropriate personal protective equipment and will be taking extra steps to ensure the ships remain regularly cleaned, disinfected, and sanitized in accordance with federal and provincial health authority guidelines. This includes thorough cleaning and disinfecting of high-touch surfaces every two hours while guests are on board, regular handwashing, hand sanitizer stations throughout the ship, limiting the number of crew members handling food plates, and the use of an electro-statically charged fogger machine for disinfecting all types of surfaces within public spaces and during cabin turnovers.
- Food service will consist of our usual high-end plated meals, served by crew along with individually plated or wrapped snacks. Buffet-style food services will not be available at this time.
- Hand sanitizer is available throughout the vessels.
- Our trips take place in the natural world, far from communities and other people.
- There is plenty of deck space with seating on our ships to enjoy the pure, fresh air of the west coast. Most on board cabins have doors and windows that open to the fresh air outside. All shared spaces have plenty of fresh air moving through them from doors opening to the deck.
- At this time, our trips will not be entering any First Nations or small coastal communities to respect their wishes and ensure their safety.

COVID-19 POLICIES & UPDATES FALL 2020

Limited Spaces on Small Number of Trips

- We are limiting the number of guests on each trip for the purposes of social distancing. On Cascadia, this will be 50% of normal capacity, so there will be only 12 guests. There will still be the same number of crew and guides, so we hope you are able to enjoy a very exclusive experience.

Payment

- You will reserve your cabin now but we will hold off processing your payment until we make the decision that we will be able to meet the minimum of passengers on each trip, and of course, we will let you know before we process your payment.
- The revised cancellation policy for these trips is that the fare is non-refundable as of 35 days before the departure date. This is because we must provide a month's notice to our crew if a trip will run or not. If we cancel a trip, we will fully refund your fare, even if it's within the 35-day period.

Managing Bookings

- Because we have such a limited number of guests, we must fill the available spots in order for each trip to run. So we are opening a selection of the trips in our schedule for booking to start with. We will fill the trips that are open, and then we will confirm more sailings if there is demand for more.
- To begin, we have opened trips in our schedule for MV Cascadia. If we have enough interest for MV Swell, we will then open her schedule. If you are interested in a trip that is not yet open for booking, you should still let us know of your interest. If there is enough initial interest we'll open those trips right away.



“It is a stunning example of design, comfort and class. It is purpose-built to explore.”

- LawTalk, New Zealand Law Society

About Cascadia

The go-anywhere MV Cascadia was built to take you to the wild corners of the world, while providing a level of luxury that cannot be found elsewhere on this coast. With just 24 guests, Cascadia is bright and spacious. Find comfort and solitude in your private cabin or enjoy time in any of the interior or outdoor lounges, or the “open” bridge. Her large windows bring the outside in, and her separate dining area becomes a sophisticated “long table” event for meals.

SHIP TYPE:

Power Catamaran

NUMBER OF GUESTS:

24 (12 max in fall 2020)

NUMBER OF PRIVATE CABINS:

12

LENGTH OVERALL:

138 feet

BEAM (WIDTH):

42 feet

NUMBER OF DECKS:

3

Special Features

- » Spacious cabins and lounges.
- » Spectacular aft deck lounge and dining area for alfresco meals or before dinner drink.
- » Large windows and vistas from all public areas and many cabins.
- » 360° views from rooftop spa

Public Area

- » Main lounge and beverage area.
- » Dining area.
- » Terrace lounge and dining area.
- » Upper deck open air lounge.
- » Open bridge.
- » Forward deck seating.

Expedition Equipment

- » Rugged shore boats.
- » Multiple kayaks.
- » Hydrophone (for listening to whales).
- » Video microscope and presentation screen.
- » Portable, mini aquariums and plankton tow.
- » Fishing gear.

Cabin Information

- » Private ensuite bathrooms.
- » Roomy wardrobes with hangers.
- » Individual climate control.
- » Category 1: Queen bed or two twins, portholes with natural light, corridor access, 160 sq. ft. Names: Campania, Cortes, Hanson, Kunghit, Penelakut, Salt Spring.
- » Category 2: Queen bed or two twins, large windows, door to deck and corridor, 195 sq. ft. Names: Admiralty, Calvert, Moresby, Vancouver.
- » Category 3: King size bed, large windows with view, door to deck and corridor, 235 sq. ft. Names: Prince of Wales and Princess Royal.

OUR SHIPS | CASCADIA



OUR SHIPS | CASCADIA

SHIP LAYOUTS

MV Cascadia

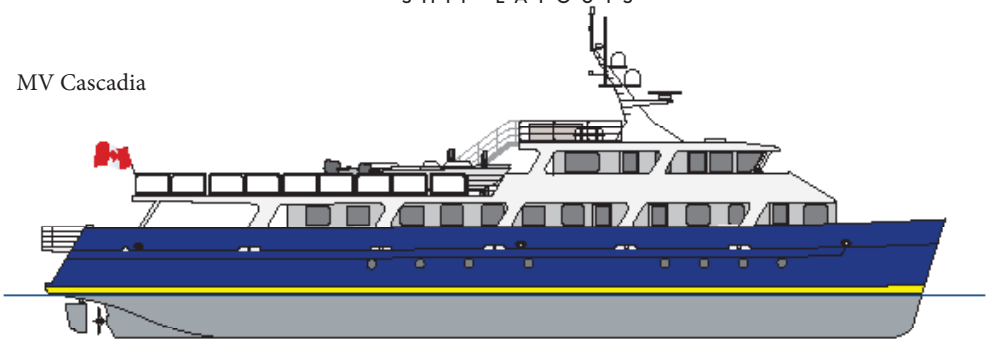

Upper Deck

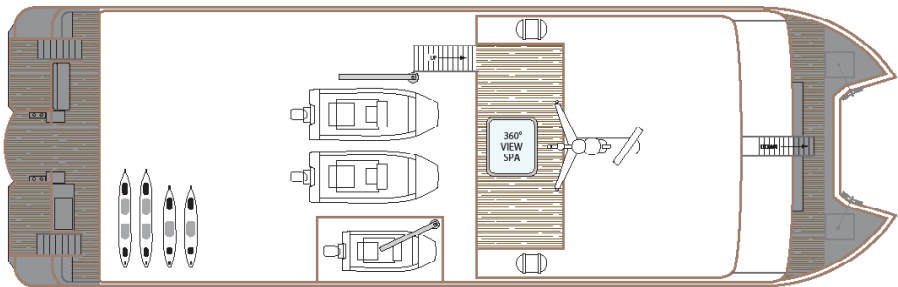

Bridge Deck

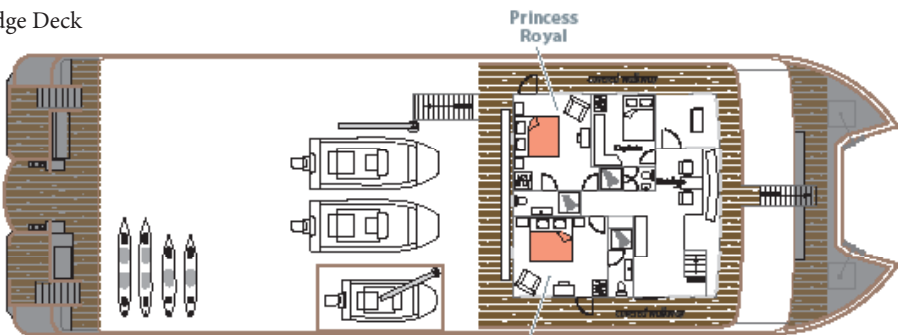

Main Deck

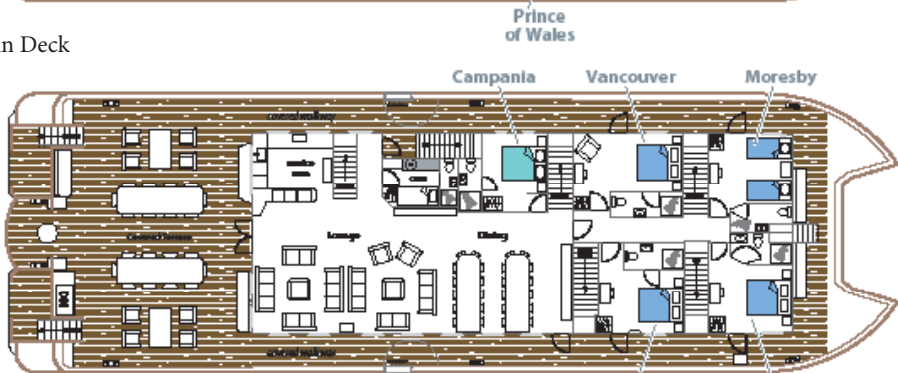

Lower Deck

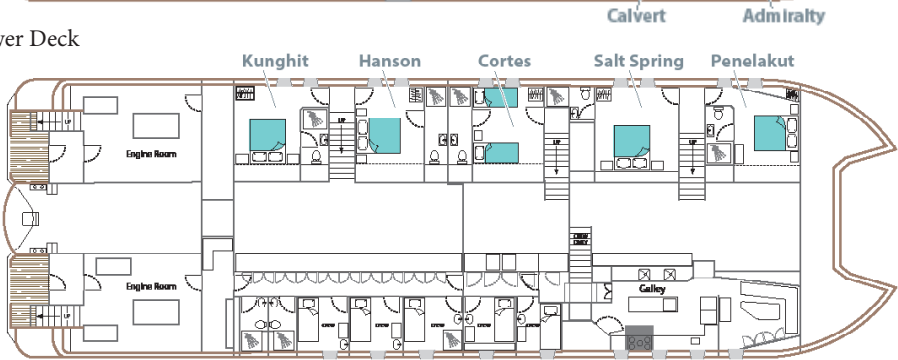



“A truly superlative vacation,
adventure and learning
experience.”

- Bill P. on TripAdvisor, 2018

“A lovingly restored tugboat, built in 1912. The Swell has 6 guest cabins and offers all the comforts of home.” - MandHMB2016, TripAdvisor

About Swell

Swell is an authentic, coastal tugboat. Her small size and handsome character prove that great things come in a small package.

Her salon is both reading room and lodge dining room for meals. Her cabins are beautifully and lovingly decorated, but they are not hotel rooms. They are authentic, small boat cabins. This means the beds are non-standard sizes but are comfortable. There are door sills to step over to enter each cabin. So step aboard without thinking of cabins as hotel rooms, but rather as cozy cabins on a real heritage ship.

SHIP TYPE:

**Tugboat
(converted)**

NUMBER OF GUESTS:

12 (8 max in fall 2020)

NUMBER OF PRIVATE CABINS:

6

LENGTH OVERALL:

88 feet

BEAM (WIDTH):

22 feet

NUMBER OF DECKS:

3

Special Features

- » Cabins have direct-to-deck access and ensuite bathrooms.
- » Hot tub (Jacuzzi) on upper aft deck.
- » Authentic custom tugboat history and build.

Public Area

- » Salon and dining area with coffee/tea bar, comfortable seating, small library and presentation screen.
- » “Open” wheelhouse: Join your crew in the classic wheelhouse, with excellent views and comfortable seats, where you can learn about navigation.
- » Aft deck lounge, main deck: An enclosed, covered lounge, you’re comfortable and protected but still relaxing ‘outside’.
- » Aft deck lounge, upper deck: An open-air, partially covered deck, protected from the breeze. Relax here on a comfy settee with blankets.

Expedition Equipment

- » 2 rugged, rigid-hull shore boats.
- » 4 kayaks.
- » Hydrophone (for listening to whales).
- » Video microscope and presentation screen.
- » Portable, mini aquariums and plankton tow.
- » Fishing gear.

Cabin Information

- » Private ensuite bathrooms.
- » Individual climate control.
- » Outside location (windows to natural light).
- » Category 1: Two up and down single bunks, 57 sq. ft. Names: Red Alder.
- » Category 2 option 1: Double bed with angled foot. Under bed storage. 80 sq. ft. Names: Sitka Spruce, Western Hemlock.
- » Category 2 option 2: Two large up and down bunks. Small desk. 80 sq. ft. Names: Arbutus.
- » Category 3: Queen-size bed, largest cabins and floor space, 120 sq. ft. Names: Cedar, Douglas Fir.



OUR SHIPS | SWELL

SHIP LAYOUTS

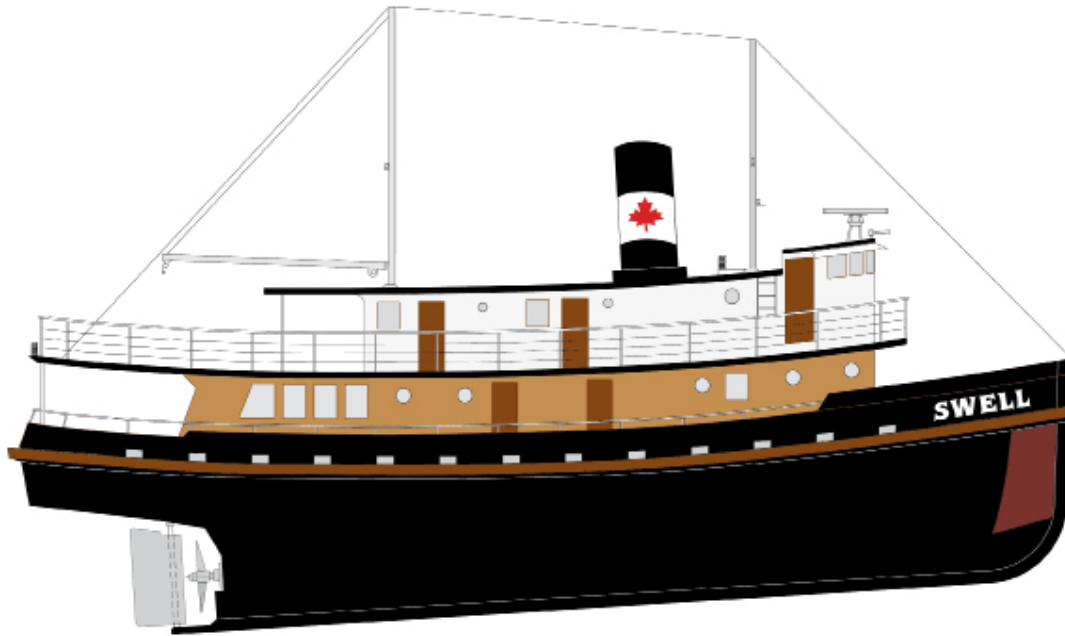

Upper Deck

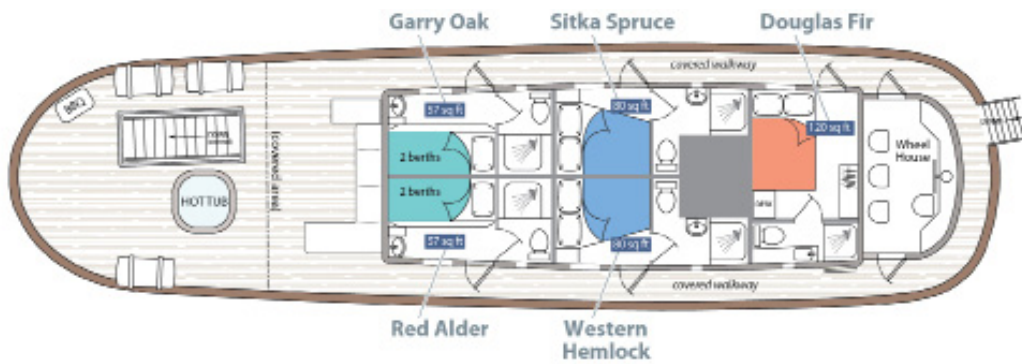

Main Deck

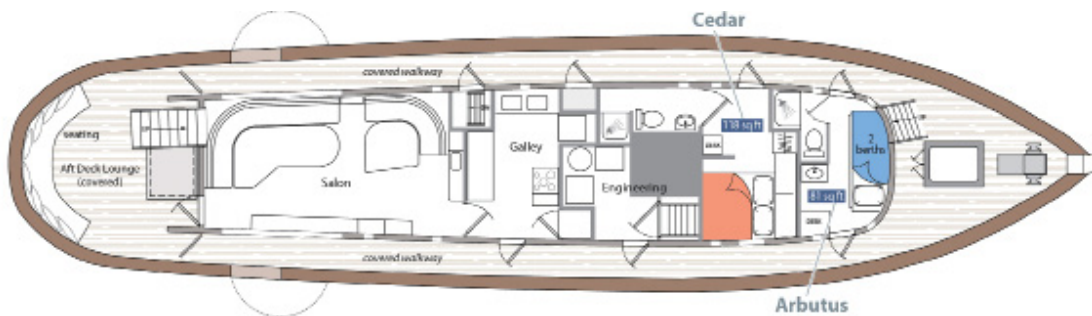

ALL-INCLUSIVE HIGHLIGHTS



What's Included

- » All accommodation and warm hospitality on our boutique ships, and local lodges if your trip includes a lodge stay.
- » All shore trips, wildlife viewing, and zodiac excursions guided by our expert, knowledgeable crew, naturalist and guides.
- » All cultural site visits, and all additional local guides. All permits and fees.
- » All meals and snacks, prepared freshly by our chef. Meals offer great variety, and highlight local specialties.
- » All beverages including coffee, tea, juices and sodas, filtered water, wine and craft beer. Note that alcohol is not a large focus of our trips.
- » Open wheelhouse. You are welcome to come into the ship's wheelhouse, where your crew navigate the ship.

- » You are at times welcome to take the helm under the crew's guidance, and help sail on the sailing ship.
- » Use of gear on board including kayaks, fishing gear (with permit), and rubber boots.

Your Trip Supports Our Conservation-Based Economy

By travelling with Maple Leaf, you are part of the important, emerging, conservation-based economy on the coast. We are a coast-owned and operated business, and 99% of the money from the trips stays within the coastal economy, providing meaningful and inspiring work that helps rather than hinders the coast.

YOUR GUIDES AND CREW



The soul of the coast

Although our guests visit for the nature and culture, they say overwhelmingly that it was the crew that made their trips so special. Skilled *and* welcoming, each person is dedicated to sharing their knowledge to make a memorable trip for you.

You'll also meet other locals onshore -- community leaders or elders, researchers, and other local guides.

Maple Leaf Adventures has been involved in important land-use, conservation and sustainable industry development on the coast for over 30 years. Our connections to what is happening on the ground and in government, as well as what is being discovered, run deep, bringing you access to special people and places.

Some of the Maple Leaf Adventures crew and guides, from top left: Chef Yasmin Ashi, Naturalist Misty MacDuffee, Captain Greg Shea and Captain Phoebe Rose, Naturalist Jeff Reynolds, Penelakut Elder Florence James, Captain Dave Hollis.

FREQUENTLY ASKED QUESTIONS

Eligibility

Anyone is eligible so long as they are: enthusiastic about participating; amenable to the vagaries of weather; agile enough to clamber in and out of shore vessels in an area where there are no docks, walk along an uneven shoreline, step over a raised door sill, and climb a short steep staircase; and friendly enough to get along in the relatively close quarters of a yacht. We have had people on board as much as 80+ years of age. However, our trips are not suitable for people of failing health or physical disabilities.

Dietary accommodation?

Yes. If you advise us in the pre-trip forms we can accommodate most dietary requirements.

Shore time – will I get ashore?

A. Yes—usually a few times a day. Each shore trip is usually between 1 and 3 hours in length.

Kayaks

You are welcome to paddle in the bays we anchor in.

Operating history

We have been operating since 1986.

Can I help sail?

Aboard our sailing ship you are welcome to lend a hand when we sail, but it is optional.

Will I be seasick?

Sea sickness on our trips is rarely a problem as your trip is on a sturdy and sea-kindly ship. We travel short distances in protected waters and go ashore often.

I've never been on a boat – is that OK?

Yes. You are aboard as our guest and we will look after you very well.

Single supplement

On the Maple Leaf, there is no single supplement. If the trip fills, you will share with another single person of your own sex. On Swell and Cascadia there is a 50% single supplement for a cabin (category 1 or 2 only). Ask us about sharing on Cascadia.

The other guests

Our guests are people like you, who are interested in high quality experiences and in learning about the natural world and/or culture and enjoy the path less travelled.

THE YEAR AT A GLANCE

MONTH	APR	MAY	JUN	JUL	AUG	SEPT	OCT
ALASKA			🚣	🚣	🚣		
GREAT BEAR RAINFOREST		🚣	🚣	🚣	🚣	🚣	🚣
HAIDA GWAI		🚣	🚣	🚣			
GULF ISLANDS	🚣						🚣
BROUGHTON ARCHIPELAGO				🚣	🚣		🚣
VANCOUVER ISLAND & DESOLATION SOUND	🚣	🚣		🚣			🚣

HOW TO GET TO YOUR TRIP



Airport Access

Our BC and Alaska trips originate from ports along the coast that are serviced by regularly scheduled flights. In BC, all of these flights originate from Vancouver International Airport, in Vancouver, BC. If you are flying from outside the area, and you are wondering where you need to get to in order to connect to your trip, then Vancouver International Airport is the answer.

For Alaska, any air travel to or from Alaska goes via Seattle-Tacoma airport, in Washington State, USA.

You may like to consult our website ("How to Get to Here") for a map showing these flights and ports.

We provide all of this information plus more detail and guidance in the Welcome Aboard package that you will receive upon booking your place with Maple Leaf. We are also happy to help any time!

Ferries

Ferries transport passengers between Vancouver and Victoria, Vancouver and Nanaimo, Port Hardy and Prince Rupert, Prince Rupert and Haida Gwaii, Seattle and Victoria, and Alaskan ports and Prince Rupert. Travelling by ferry requires careful planning and sometimes a car.

Driving

If you wish to drive to and/or from your trip, you may be able to. It's best to email or phone us or your travel agent for further information.

Staying Beforehand or Afterward

Our Welcome Aboard packages lists some places you may wish to stay at before or after your trip.

Travel Agent

If you would like the assistance of a travel agent, we are happy to provide contact information for one who has worked with our guests.

Booking and Cancellation Policy

To avoid disappointment, your reservation should be made early. The number of participants in each program is limited, and the demand is high. Trips can sell out early.

Deposit: A deposit of one third of the price of the trip will reserve your space for any trip.

Balance: The balance is due 120 days prior to departure.

Cancellations: If you are unable to participate and cancellation occurs at least 120 days prior to the departure date of your trip, the full amount of your deposit is refundable, minus a \$200 admin fee per person to cover costs we cannot recover. If cancellation occurs less than 120 days prior to the departure date of your trip, the fare is non-refundable. We highly recommend cancellation insurance. See next page for details.

Group Bookings: For large group bookings, such as a family charter of the entire ship, the booking and cancellation policy may be different - please contact us for information.

BOOKING YOUR ADVENTURE



Payment Methods

We accept Visa, Master Card, Discover, cheque, money order or bank transfer.

Included in the Price

A. See “What’s Included” earlier.

Not included in the price:

- » Transportation to the trip’s point of origin (unless booking with one of our promotions).
- » Goods and Service Tax (Canadian trips only, 5%)
- » Crew gratuities
- » Sustainability Fee of \$200. As an ecotourism company, we work with local communities, do things the right way, and protect the environment. Responsible operations cost a little more. We extract from the fare a token amount of the increased costs that go towards sustainability to recognize this.
- » For solo travellers booking a whole cabin on Swell or Cascadia, a 50% single supplement. (There is no single supplement on Maple Leaf.)

Cancellation Insurance

We highly recommend cancellation insurance, which protects you if you have to make a late cancellation in certain cases (such as a medical emergency). There are several kinds available for different cancellation reasons. Cancellation and any needed medical insurance can be purchased through a travel agent. This should be done at the time your booking is nonrefundable.

Pre-Trip Information Package

We will send you a comprehensive Welcome Aboard package. It includes information on how to get to your trip, what to wear and bring, and other tips for your trip. It also includes an emailed questionnaire and a passenger agreement. There is also a reading list, for those who like to do pre-trip reading.

Full Ship Charters

Charter an entire trip for your family and friends and share quality time without worrying about logistical details. Children are welcome on fullship charters. Contact us for details.

Note: Full ship charters require advance planning, as the trips are popular and once a trip has bookings, it can no longer be exclusively yours.

How to Book Your Trip

To book, we welcome your call or email. We complete bookings by telephone.

Contact

+1-250-386-7245 or 1-888-599-5323

MapleLeafAdventures.com

info@MapleLeafAdventures.com



About Maple Leaf Adventures

Maple Leaf has received the Parks Canada Sustainable Tourism Award for promoting the appreciation of Canada's natural, cultural and aesthetic heritage, while also protecting them.

As a long time practitioner of ecotourism, Maple Leaf Adventures pioneered travel in BC's Great Bear Rainforest and northwestern Vancouver Island, and we have made significant contributions to conservation.

Our trips are operated by expert locals and recognize the traditional territory of coastal First Nations, with whom we work, through protocol agreements. *National Geographic Adventure* has rated Maple Leaf Adventures one of the "Best Adventure Travel Companies on Earth".

All photographs in this brochure are captured on trip by our crew: Jeff Reynolds, Greg Shea, Philip Stone, Grace van Helvoirt, Kayleen VanderRee, Kevin Smith, Scott Forsyth, Tavish Campbell, Brandon Harvey, Sherry Kirkvold and Matt Whelan.

Contact

+1-250-386-7245 or 1-888-599-5323

MapleLeafAdventures.com

info@MapleLeafAdventures.com